

**2024 JLPT
Test Site Information – Boston, MA**

Test Date: Sunday, December 1, 2024

Test Location: Showa Boston Institute
420 Pond Street, Boston, MA 02130
Tel: (617) 522-0080
URL: <https://www.showaboston.edu/>

Reporting Time and Test Schedule:

- Please arrive at the test site during the scheduled reporting time. Your check in location is the 420 Pond Street building. If you are driving, park in the designated areas on the map (attached). Parking fee is \$5.00 per car (cash only). Upon arriving at the test site, report to your assigned classroom. You must present your **test voucher** (printout) and proper **photo identification** to a proctor to be allowed into the classroom.
- Since the test takes place during winter when severe weather could affect roads and public transportation, please make sure you allow for extra time to reach the test site as well as to return to your destination.

Level	Report Time ID Check	Test Instruction	Language Knowledge & Reading	Break	Test Instruction	Listening
N1	12:30- 1:00 (30 min)	1:00-1:10 (10 min)	1:10-3:00 (110 min)	3:00-3:20 (20 min)	3:20-3:25 (5 min)	3:25-4:20 (55 min)
N2	12:30- 1:00 (30 min)	1:00-1:10 (10 min)	1:10-2:55 (105 min)	2:55-3:15 (20 min)	3:15-3:20 (5 min)	3:20-4:10 (50 min)

Level	Report Time ID Check	Test Instruction	Vocabulary	Break	Test Instruction	Grammar & Reading	Break	Test Instruction	Listening
N3	12:30-1:00 (30 min)	1:00-1:10 (10 min)	1:10-1:40 (30 min)	1:40-1:55 (15 min)	1:55-2:00 (5 min)	2:00-3:10 (70 min)	3:10-3:25 (15 min)	3:25-3:30 (5 min)	3:30-4:10 (40 min)
N4	12:30-1:00 (30 min)	1:00-1:10 (10 min)	1:10-1:35 (25 min)	1:35-1:50 (15 min)	1:50-1:55 (5 min)	1:55-2:50 (55 min)	2:50-3:05 (15 min)	3:05-3:10 (5 min)	3:10-3:45 (35 min)
N5	12:30-1:00 (30 min)	1:00-1:10 (10 min)	1:10-1:30 (20 min)	1:30-1:45 (15 min)	1:45-1:50 (5 min)	1:50-2:30 (40 min)	2:30-2:45 (15 min)	2:45-2:50 (5 min)	2:50-3:20 (30 min)

Note1: There will be a short break between sections. The schedule above is subject to change in the event of any unexpected situation at the test site.

Note2: The running time of the Listening comprehension may fluctuate by plus or minus 2 to 3 minutes depending on the year. Therefore, the end time of the final subject may vary slightly

Special Accommodations:

Test schedule for test taker(s) with special accommodations is (are) as follows:

Reg.#	Report Time ID Check	Test Instruction	Vocabulary	Break	Test Instruction	Grammar & Reading	Break	Test Instruction	Listening
N4 40016 40025	12:30-12:40 (10 min)	12:40-12:50 (10 min)	12:50-1:30 (40 min)	1:30-1:45 (15 min)	1:45-1:50 (5 min)	1:50-3:15 (85 min)	3:15-3:30 (15 min)	3:30-3:35 (5 min)	3:35-4:30 (55 min)

N5 50034	12:30-12:40 (10 min)	12:40-12:50 (10 min)	12:50-1:10 (20 min)	1:10-1:25 (15 min)	1:25-1:30 (5 min)	1:30-2:10 (40 min)	2:10-2:25 (15 min)	2:25-2:30 (5 min)	2:30-3:00 (30 min)
N5 50037	12:30-12:40 (10 min)	12:40-12:50 (10 min)	12:50-1:20 (30 min)	1:20-1:35 (15 min)	1:35-1:40 (5 min)	1:40-2:40 (60 min)	2:40-2:55 (15min)	2:55-3:00 (5 min)	3:00-3:45 (45 min)

Note: The above schedules are approximate. Subject to change depending on the headquarters' decision on the application for Special Accommodation in November.

Room Assignment:

- Your room assignment is based on the last 5 digits of your registration number, which is printed on your test voucher.
- Room assignments are subject to change on the test day. In case there is a room change, a notice will be posted.

Test Level	Registration Numbers	Location (Classroom #)	# of Examinees
N1	10001-10020	British School Classroom 310	20
	10021-10040	British School Classroom 309	20
	10041-10060	British School Classroom 308	20
	10061-10080	British School Classroom 304	20
	10081-10098	British School Classroom 305	18
	10099-10115	British School Classroom 306	17
N2	20001-20010	Building 420 C Classroom C101	10
	20011-20026	Building 420 C Classroom C102	16
	20027-20042	Building 420 C Classroom C103	16
	20043-20052	Building 420 C Classroom C104	10
	20053-20063	Building 420 Study 1	11
	20064-20080	Building 420 Study 2	17
N3	30001-30035	Building 420 Provost Hall	35
	30036-30051	Building 420 Study 3	16
	30052-30066	Building 420 Study 4	15
N4	40001-40017 (excluding 40016)	Building 420 Study 5	16
	40018-40034 (excluding 40025)	Building 420 Study 7	16
	40035-40051	Building 420 Study 9	17

N4 (SA)	40016	Building 420 Study 6	1
	40025	Building 420 Study 8	1
N5	50001-50020	British School Classroom 202	20
	50021-50033	British School Classroom 204	13
	50035-50047 (excluding 50037)	British School Classroom 206	12
N5 (SA)	50034	Building 420 Small Conference Room	1
	50037	Building 420 Study 10	1
Administration Office		Building 420 Rainbow Hall	

General Testing Guidelines:

- Dress so that you can adapt to any room temperature. DO NOT wear any clothing with visible Japanese writing.
- Guests who accompany you to the test center are not allowed in the classroom. The parents of test takers can wait in the lobby area of Building 420.
- You are not allowed to leave the test room until a proctor dismisses you. If you get sick during the test and must leave the room, you must notify the proctor so that the proctor can accompany you out of the room.

What to Bring to the Test Site: You **MUST** bring the following items:

1. Your **test voucher printed on a blank paper**. Electronic copies stored on mobile devices cannot be used during the test so they will NOT be accepted.
2. A **valid photo ID**. Copies are not accepted.
 - Acceptable forms of ID include driver’s license, state ID, or passport. Your ID must display your full name, photo, and date of birth. If you are a minor without another form of ID, a student ID without your date of birth is acceptable. Social security cards, credit or ATM cards, and retail credit cards are not acceptable.
 - The first and last name on your voucher must match the name on your official ID.
 - It is your responsibility to ensure that your official ID is valid (not expired) and available on the day of the test.
 - ID checks are strictly enforced. If you arrive at the test center without a valid ID, you will not be permitted to take the test.
3. Several sharpened No. 2 or HB **pencils** and an **eraser** for multiple-choice answer sheets. Pencils and erasers will not be supplied at the test center. Pens are NOT permitted. Mechanical pencils are allowed but not recommended as they may hinder machine-grading.

Prohibited Materials during the Exam:

1. Electronic equipment,
 - **cell phones** of any kind
 - **digital watches**, any devices that can record, transmit, or receive information.
 - **personal computing devices**
 - **Bluetooth devices** such as wireless earbuds/headphones, or tablets
 - **cameras**
 - **audio players/recorders**
- All devices described above must be completely turned off and stored in your bag under your seat during the test.
- If your device makes any noise or vibrates, you are disqualified. Follow the proctor's instructions if this happens, even if it is an accident. Your test score will be voided, and you will not receive a score for the test.

2. Handwritten or printed materials.
 - cheat sheets written on paper, Japanese characters on skin, clothing and personal belongings.
3. Food or drinks: You may bring small snacks and drinks to the test site and consume them outside of the exam room during breaks. Eating and drinking during the examination is only permitted for examinees who have special accommodation permission applied in advance.

Note:

- Your personal bag must fit under your seat and should not block any walkways.
- If you are traveling from a distance and have any travel bag with you, you must place them in the designated storage area prior to the start of the test and leave them there until all sections of the test are complete and you are dismissed by the proctor. Test takers can keep their travel bags in Rainbow Hall, where at least two Showa staff members will always be present.

Directions to the Test Location:

Buses from Reservoir Station (the nearest station on the D branch of the MBT’s Green Line)

- The Subway Schedule is available at: <https://www.mbta.com/>
- Showa Boston will provide shuttle-bus service from the nearest subway station to the campus for people who use public transportations.
- All shuttles arrive and depart from the lobby (420 Pond Street Building)

Extra shuttle buses will operate at the following times on Test Day: from Reservoir Station to Showa at 10:50 AM and 11:50 AM; from Showa to Reservoir Station at 5:00 PM.

Shuttle bus schedule:

Depart Showa	Depart Reservoir
9:40 AM	9:50 AM
10:40 AM	10:50 AM
11:40 AM	11:50 AM
12:40 AM	12:50 AM
1:40 AM	1:50 AM
2:40 PM	2:50 PM
4:40 PM	4:50 PM
5:40 PM	5:50 PM
6:40 PM	6:50 PM
7:40 PM	7:50 PM
8:40 PM	8:50 PM
9:40 PM	9:50 PM

Driving Directions: Available on <https://www.showaboston.edu/>

Parking Information:

- Parking is available; please follow the sign when you get to the Showa Boston gate.
- Showa Boston’s 40-acre campus can accommodate 300 cars.
- If you are driving, park in the designated areas on the map (attached).
- **Parking fee is \$5.00 per car (cash only).**



SHOWA BOSTON BUILDING 420 MAP

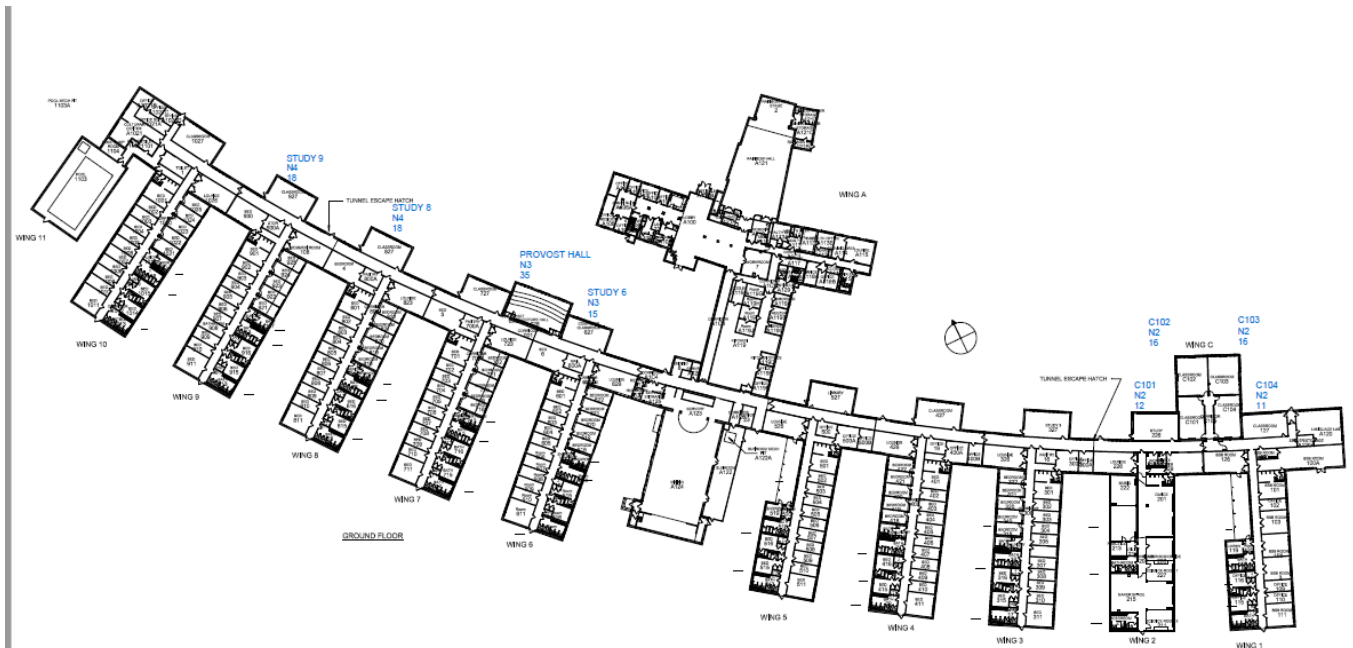

Contact:

Please direct all questions and inquiries to:
American Association of Teachers of Japanese (AATJ)
Tel: (303) 492-5487 E-mail: jlpt@aatj.org